

DESIGN ESSENTIA

architecture & design magazine



*Bold
and
Beautiful!!*



featuring

**STUDIO SAM BUCKLEY,
UNITED KINGDOM (ON COVER)**

DE SPOTLIGHT // PAGE 29

**INT-HAB
ARCHITECTURE+DESIGN**

DE SPOTLIGHT

**ASHIESH SHAH X
RITU KUMAR HOMES**

**LALITYA
BY SHIVANI AYUSH**

AZURE INTERIORS

**ZERO ENERGY
DESIGN LAB**

PURPLE BACKYARD

**VARUN BAWEJA
DESIGNS**

and many more young architects & designers of India.

DUBAI DESIGN WEEK 2021 HIGHLIGHTS //PAGE 12

VOLUME 02 ISSUE 06



DESIGN ESSENTIA MAGAZINE
www.designessentiaindianmagazine.com

DE//INDIA

follow us @demagazineindia



DE DIRECTIONS/EVENTS

//WORLD DESIGN EVENTS HIGHLIGHTS 2021

DUBAI DESIGN WEEK 2021.
THE BEST OF
#DXBDW21

12

DE PRODUCTS

//ARCHITECTURE & INTERIOR PRODUCT SHOWCASE



RITU HUMAR HOME x
ASHIESH SHAH



18

MIRAGE BY SABINE MARCELIS



22

DE PRODUCTS GUIDE,
CHRISTMAS EDITION

24

DE IMPRESSIONS

//TOP TRENDING DESIGN SHOWCASE (DE SPACES)

52

RESIDENCE IN RAIPUR
RAIPUR
By **AZURE INTERIORS**



56

HOUSE UNDER SHADOWS
KARNAL
By **ZERO ENERGY DESIGN LAB**



60

HOUSE NUMBER 7
MUMBAI
By **PURPLE BACKYARD**

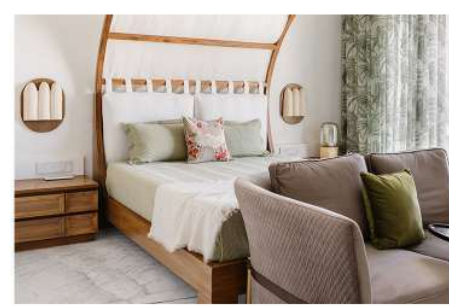

//Let's take an
alluring journey
through design
with some of the
exquisite &
beautiful spaces
designed by
today's design
trendsetters.

DE
Impressions

//In background
House under Shadows, Karnal, Haryana, India by
Zero Energy Design Lab | Page 56

House Under Shadows, Karnal

by
*Zero Energy
Design Lab*

Location: KARNAL, HARYANA

Architect: **ZERO ENERGY DESIGN LAB**

Principal Architects: SACHIN RASTOGI AND PAYAL RASTOGI

Photographer: ANDRE J. FANTHOM (NOUGHTS AND CROSSES)

DESIGN
ESSENTIA
architecture & design magazine



#DEimpressions

#DEimpressions



HOUSE UNDER SHADOWS, an integrated double-family residence in Haryana, exhibits a nature-inspired, near-net-zero design that reformulates the idea of 'India-Modern' and enables sustainable living. Located in the historic city of Karnal, a part of the NCR (National Capital Region), the House Under Shadows is a 1672-sq.m residence nestled below the sweeping shadows of the day.

Designed by Zero Energy Design Lab led by principal architects - **Sachin Rastogi and Payal Seth Rastogi**, this house is a near Net-Zero Home inspired by nature.

“The client's brief called for an expansive two-unit residence for two brothers and their families that characterizes sustainable living in the lap of nature and be openly guided by design to find the rhythm of movement and activities within the house. In response to this, the house fuses two single-floor units through a common façade and a seamless double roof that creates a sense of visual cohesion through its horizontal emphasis.” says the architects.



//above from top: House under shadows in Karnal, Haryana by Zero Energy Design Lab
Photographer: ANDRE J. FANTHOME

//from left: Sachin Rastogi and Payal Seth Rastogi; principal architects at Zero Energy Design Lab.

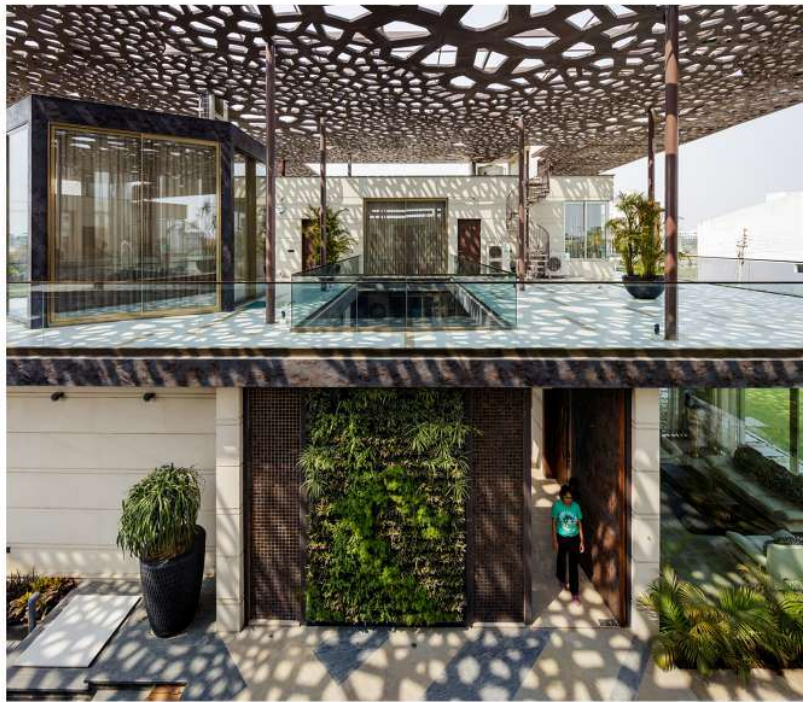

The design takes shape with a common entrance space embraced between two boxes that represent the two units, following a mirroring process thereafter and throughout. The units are punctured with two chowk-inspired rectangular courtyards, each in the form of pools that act as heatsinks. This is balanced by immediate cantilevers that run along the units, shielding internal and external walls with shade; the cantilevers also enable transition spaces across. The cantilevers and the courtyard areas facilitate social cohesion and seamless movement between spaces that steers one away from the sense of confinement typically felt within walls.

The layout of the expansive units accommodates cross-ventilated and naturally-lit interior spaces with night-time areas (sleeping spaces) oriented towards the south-west and day-time areas (living spaces) towards the north-east. In other words, bedrooms have glazed windows in the north-west which allow minimum heat and glare, thereby creating a calm oasis for unwinding, while offering broad views of the outdoor landscape. The living spaces are shielded from the harsh south-west sun and open out into the courtyard to allow for abundant ingress of natural daylight. Other areas include the kitchen and utility, bar, powder room and servant's quarter with the vertical circulation element – staircase positioned at the centre of the south-west side. The first floor accommodates a bedroom with toilet, lounge, powder room, pantry, store, and a multipurpose hall. The design of the multipurpose hall draws inspiration from the 'chhatris' that are elevated, and dome-shaped pavilions found in traditional Indian architecture.

HOUSE UNDER SHADOWS IN KARNAL, HARYANA BY ZERO ENERGY DESIGN LAB
PHOTOGRAPHER: ANDRE J. FANTHOMÉ

An environmentally conscious approach towards the design is evident through the use of local materials with low embodied carbon and neutral tones that enable heat reflection, which reduces mechanical cooling loads while creating visual lightness in elevation. The walls are dry clad with Gwalior mint stone to enhance thermal mass performance and create a unique finish. Additionally, a leather finish on stone is provided to render a natural texture on the stone.

The **House Under Shadows** is a prominent near-net-zero double-family residence that redefines the 'Indian-Modern' taking cues from the vernacular and nature's self-forming elements and patterns like Voronoi that minimises energy consumption throughout. The playful dance of shadows inside the spaces truly captures the essence of the brief '**sustainable living in nature**' and finesse in the execution of the design.



HOUSE UNDER SHADOWS IN KARNAL, HARYANA
BY ZERO ENERGY DESIGN LAB
PHOTOGRAPHER: ANDRE J. FANTHOMIE

check full story at
www.designessentiamagazine.com